













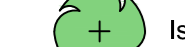
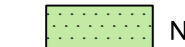

MERKINNÄT:

-  Ajorata, asfaltti
-  Kevyen liikenteen väylä, tonttijolittymä, asfaltti
-  Betonikiveys, harmaa
-  Varoitusalue, valkoinen betonikivi
-  Kenttäkiveys
-  Kivituhka
-  Istutettava lehtipuu
-  Nurmi
-  Luonnonreunatuki, V170, harmaa
-  Madallettu luonnonreunatuki, V170, harmaa
-  Hulevesiviemäri ja hulevesikaivo
-  Rakennettu hulevesiviemäri ja hulevesikaivo
-  +23.3 Kadun likimääräinen korkeusasema
-  Uusi valaisin

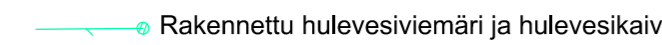
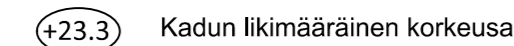

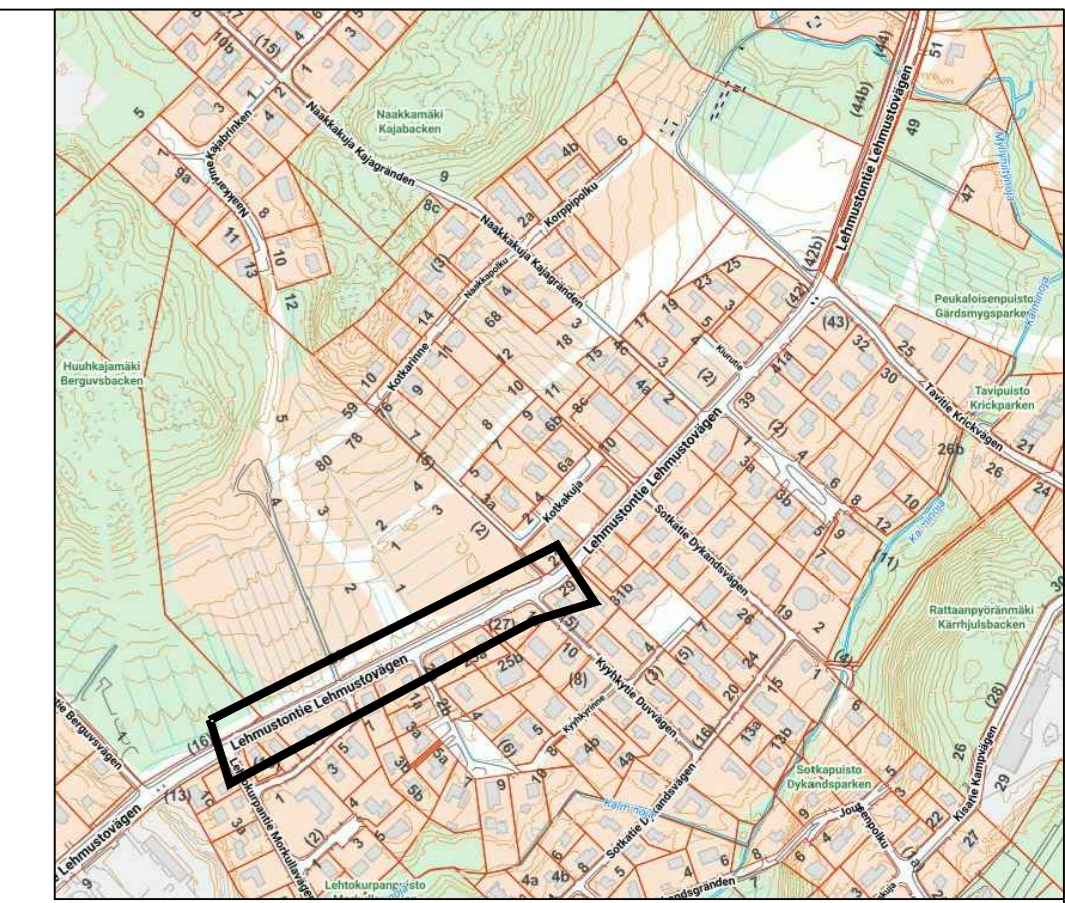
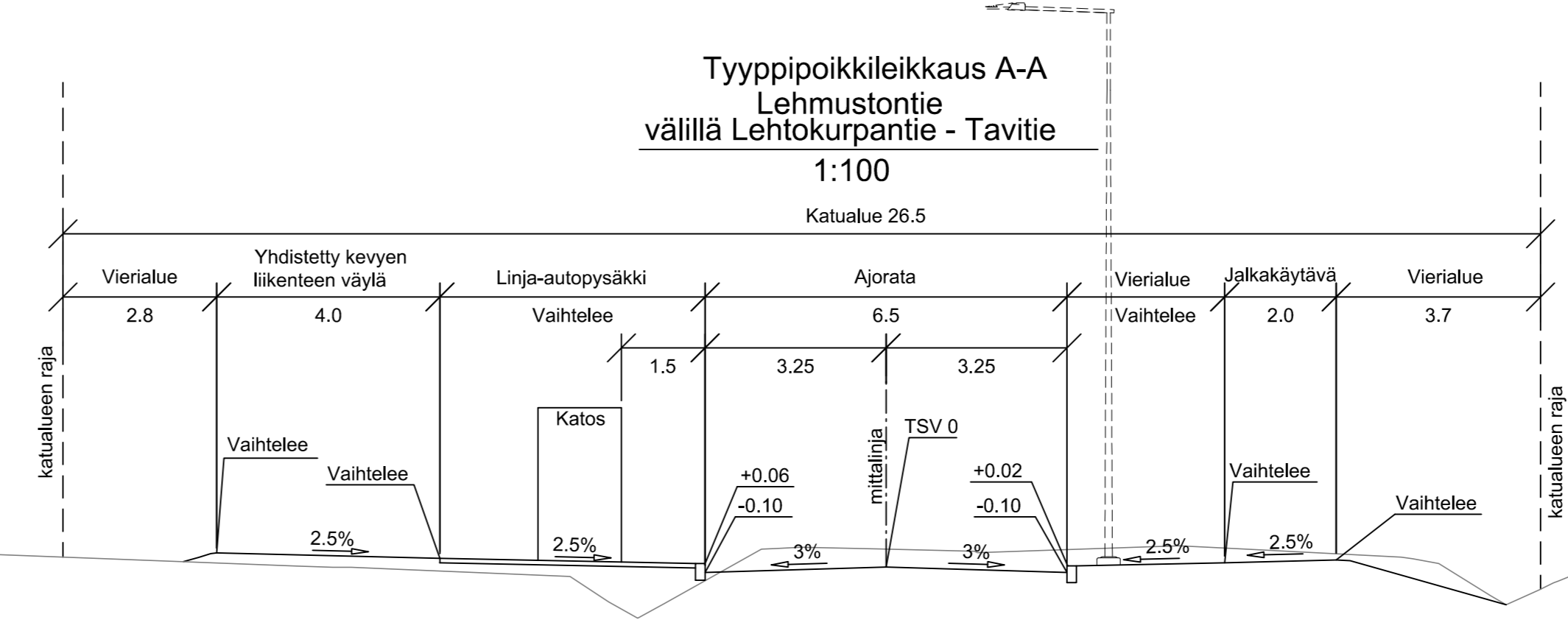
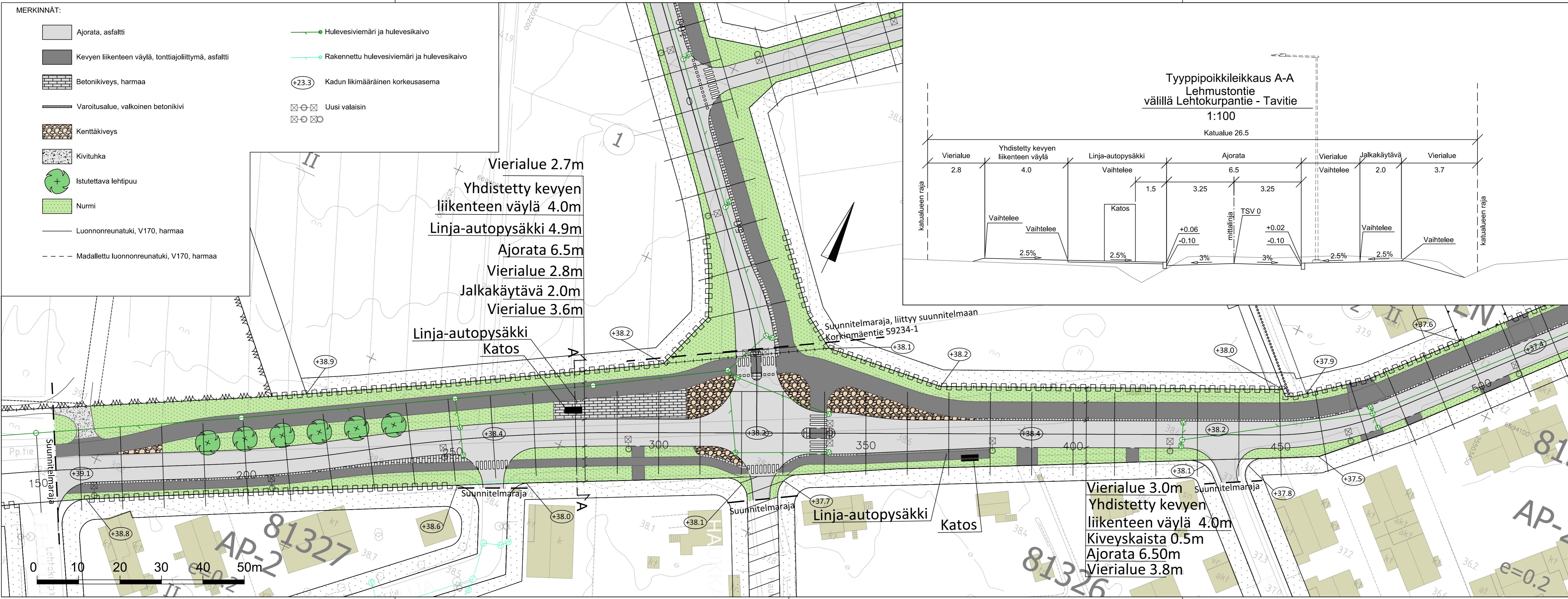
 VANTAAN KAUPUNKI KADUT JA PUISTOT		Hyv.		
		26.04.2023	Tark. Paula Luomala Suunn.	
88	VALLINOJA	LEHMUSTONTIE 002288	Mittakaava 1:100 1:500	Koord.järj. ETRS-GK25 Korkeusjärj. N2000
LEHMUSTONTIE välillä Lehtokurpantie-Tavitie KATUSUUNNITELMA			Liitt.piiir.nro	
209	HALLINNOITSEVAT KATUSUUNNITELMAT	Hyv.	Hyv.	
			Piiir.nro	
			59240-1	
GEOTEK- NIIKKA	Hyv. Tark.			 26.04.2023 Tark. Jarmo Stenvik Suunn. Juuso Jyrinki